

JOIN THE MANITOBA CLINIC

ONE MAIN FLOOR UNIT REMAINING FOR LEASE

UNIT 110 - 790 SHERBROOK ST

 **CUSHMAN & WAKEFIELD**
Winnipeg



— INCENTIVES AVAILABLE FOR QUALIFIED TENANTS —

Brett Intrater

Executive Vice President

Brett Intrater Personal Real Estate Corporation

T 204 934 6229

C 204 999 1238

brett.intrater@cwstevenson.ca

Brandi Eloquence
Associate

T 204 934 6246

C 204 996 3425

brandi.eloquence@cwstevenson.ca

Lydawn McGarry
Associate

T 204 934 8906

C 204 801 6967

lydawn.mcgarry@cwstevenson.ca



PROPERTY HIGHLIGHTS

PRIME SPACE IDEAL FOR MEDICAL USERS

- Join one of Canada's largest private multi-specialty medical clinics at Winnipeg's state-of-the-art Manitoba Clinic
- Conveniently located adjacent to the Health Sciences Centre with direct access to Notre Dame Avenue
- Perfect for paramedical services such as physiotherapy, chiropractic, massage, acupuncture, infusion, etc.
- Direct access to parkade from building with monthly parking available
- Amenities include an on-site cafe
- Shell space ready for tenant customization
- Join complimentary businesses including Shoppers Drug Mart, Connect Hearing, Visual Eyes Optometry and more

LEASE RATE: \$28.00 PSF

CAM & TAX: \$16.33 PSF (2026 EST)

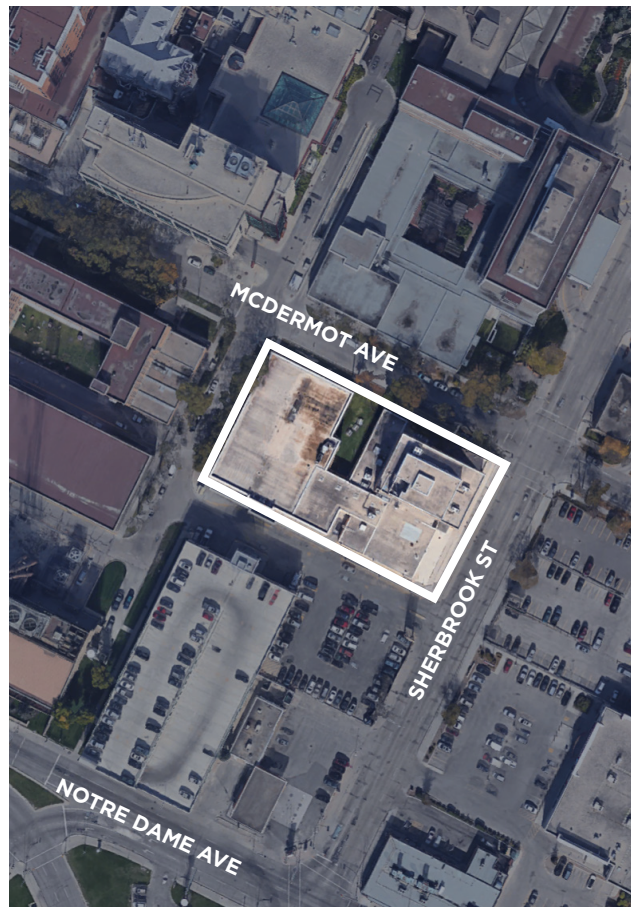

PROPERTY IMAGES



MAIN FLOOR PLAN

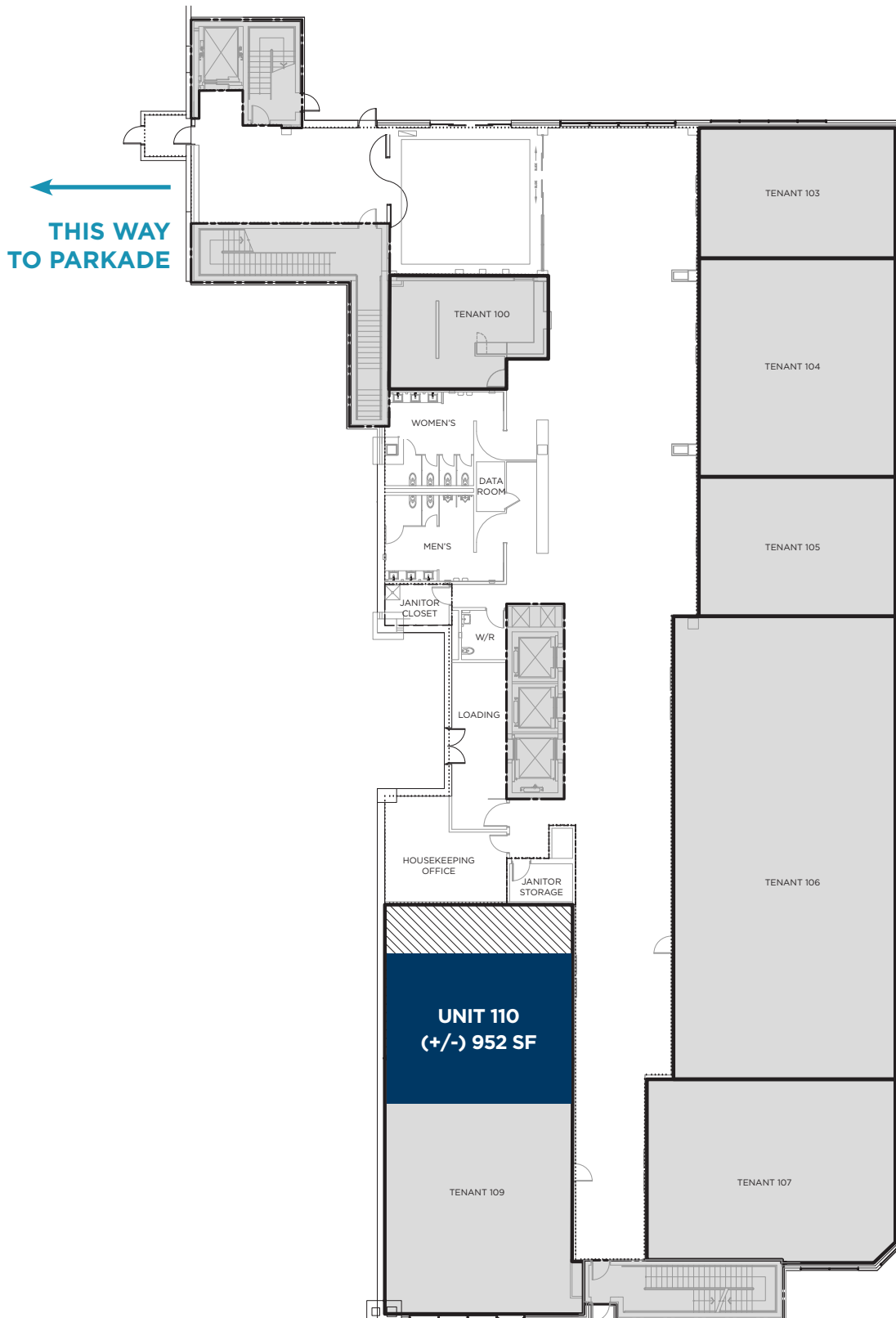

ARIEL VIEW



DRIVE TIME MAP

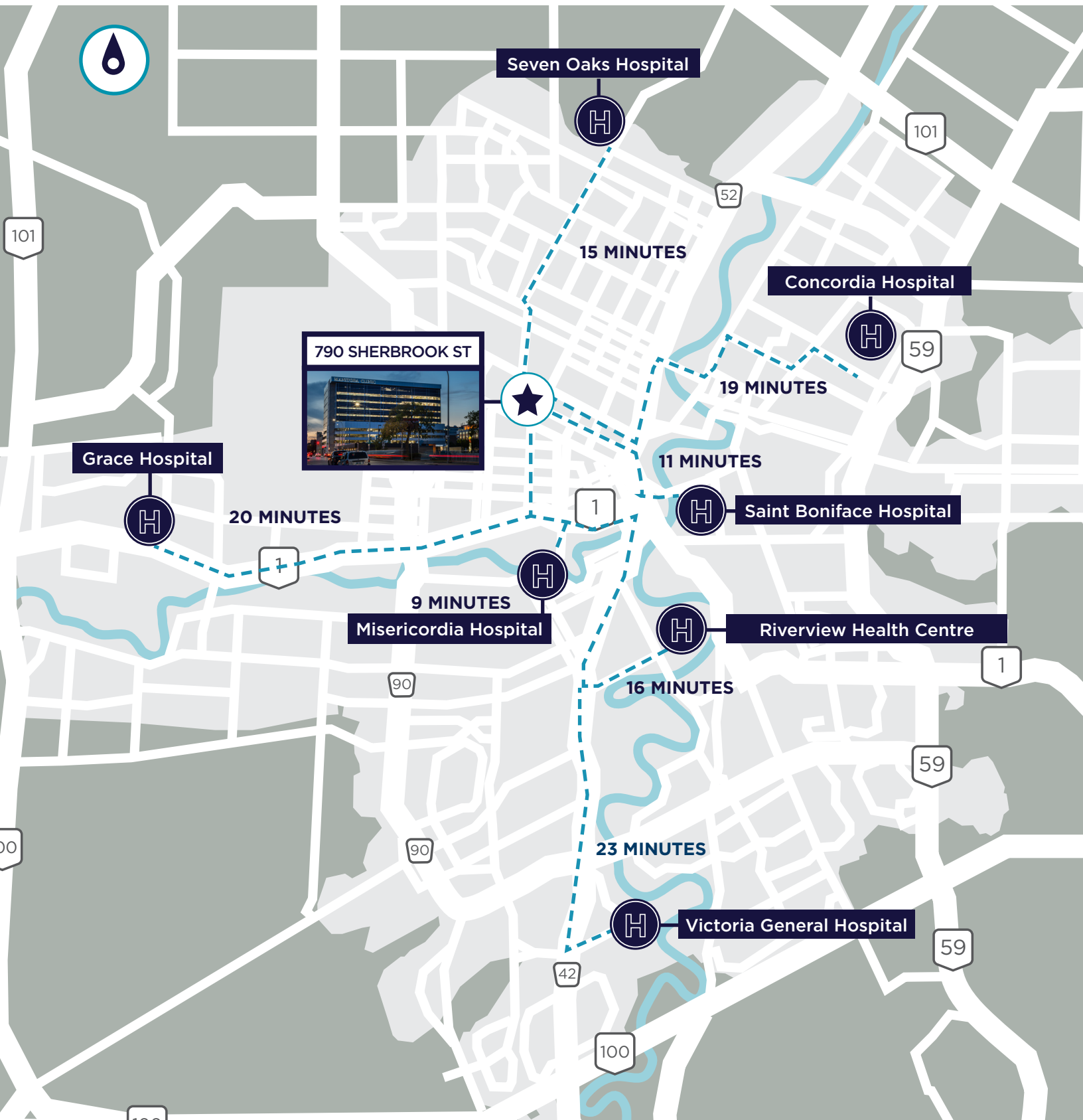

HEALTH SCIENCES CENTRE MAP

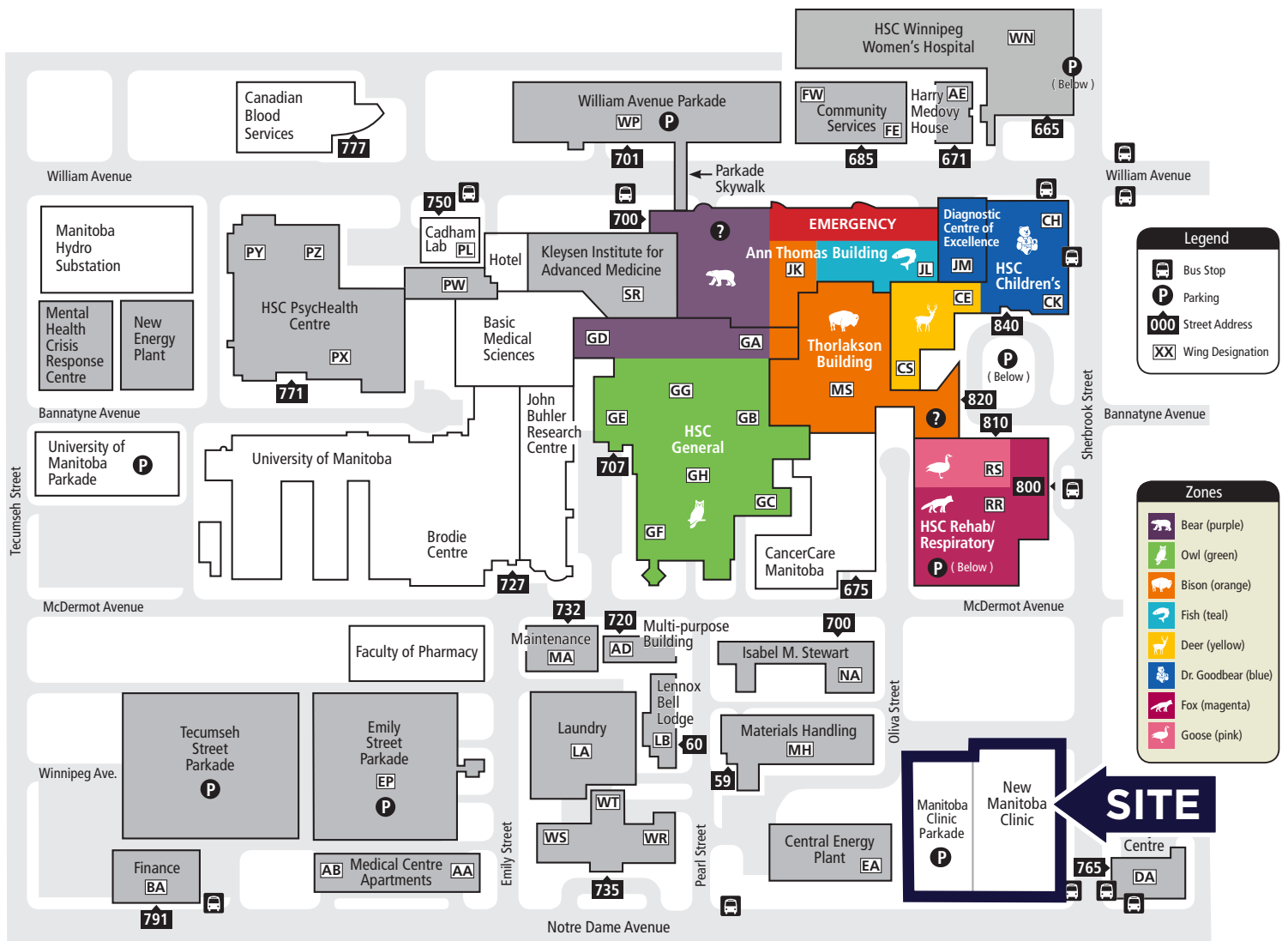



CONTACT

Brett Intrater
Executive Vice President

Brett Intrater Personal Real Estate Corporation
T 204 934 6229
C 204 999 1238
brett.intrater@cwstevenson.ca

Brandi Eloquence
Associate

T 204 934 6246
C 204 996 3425
brandi.eloquence@cwstevenson.ca

Lydawn McGarry
Associate

T 204 934 8906
C 204 801 6967
lydawn.mcgarry@cwstevenson.ca



Independently Owned and Operated / A Member of the Cushman & Wakefield Alliance ©2026 Cushman & Wakefield. All rights reserved. The information contained in this communication is strictly confidential.

This information has been obtained from sources believed to be reliable but has not been verified. NO WARRANTY OR REPRESENTATION, EXPRESS OR IMPLIED, IS MADE AS TO THE CONDITION OF THE PROPERTY (OR PROPERTIES) REFERENCED HEREIN OR AS TO THE ACCURACY OR COMPLETENESS OF THE INFORMATION CONTAINED HEREIN, AND SAME IS SUBMITTED SUBJECT TO ERRORS, OMISSIONS, CHANGE OF PRICE, RENTAL OR OTHER CONDITIONS, WITHDRAWAL WITHOUT NOTICE, AND TO ANY SPECIAL LISTING CONDITIONS IMPOSED BY THE PROPERTY OWNER(S). ANY PROJECTIONS, OPINIONS OR ESTIMATES ARE SUBJECT TO UNCERTAINTY AND DO NOT SIGNIFY CURRENT OR FUTURE PROPERTY PERFORMANCE.