

FOR LEASE

Unit A

1000 Waverley Street

Fully Developed Office
Space Available

Ryan Munt
Executive Vice President

Ryan Munt Personal Real Estate Corporation
T 204 928 5015
C 204 298 1905
ryan.munt@cwwinnipeg.com

Karin Thielmann
Senior Associate

T 204 934 6226
C 204 470 4715
karin.thielmann@cwwinnipeg.com



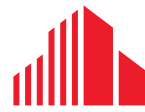

**CUSHMAN &
WAKEFIELD**
Winnipeg

FOR LEASE

1000 Waverley Street



(+/-) 16,370 – 21,468 sf Available with 70 Parking Stalls

PROPERTY HIGHLIGHTS

- Fully-developed office space located in highly desirable Southwest Winnipeg
- Mix of private offices, large open areas, three boardrooms, four large training rooms, photo copier/mail room, one large lunch room, two kitchenettes and a garage with a grade loading door
- Well-situated within densely populated, amenity-rich area
- Building signage available with excellent visibility along Waverley Street
- City of Winnipeg transit stops going North and South located directly outside
- (+/-) 70 parking stalls available on site

Lease Rate: TBD

CAM & Tax: \$7.55 psf (2026 est.)

Includes utilities

Plus mgmt fee 5% of gross rent

FOR LEASE

Unit A 1000 Waverley St

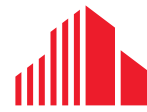

CUSHMAN &
WAKEFIELD
Winnipeg



FOR LEASE

Unit A 1000 Waverley St

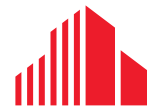

CUSHMAN &
WAKEFIELD
Winnipeg



FOR LEASE

Unit A 1000 Waverley St

FLOOR PLAN

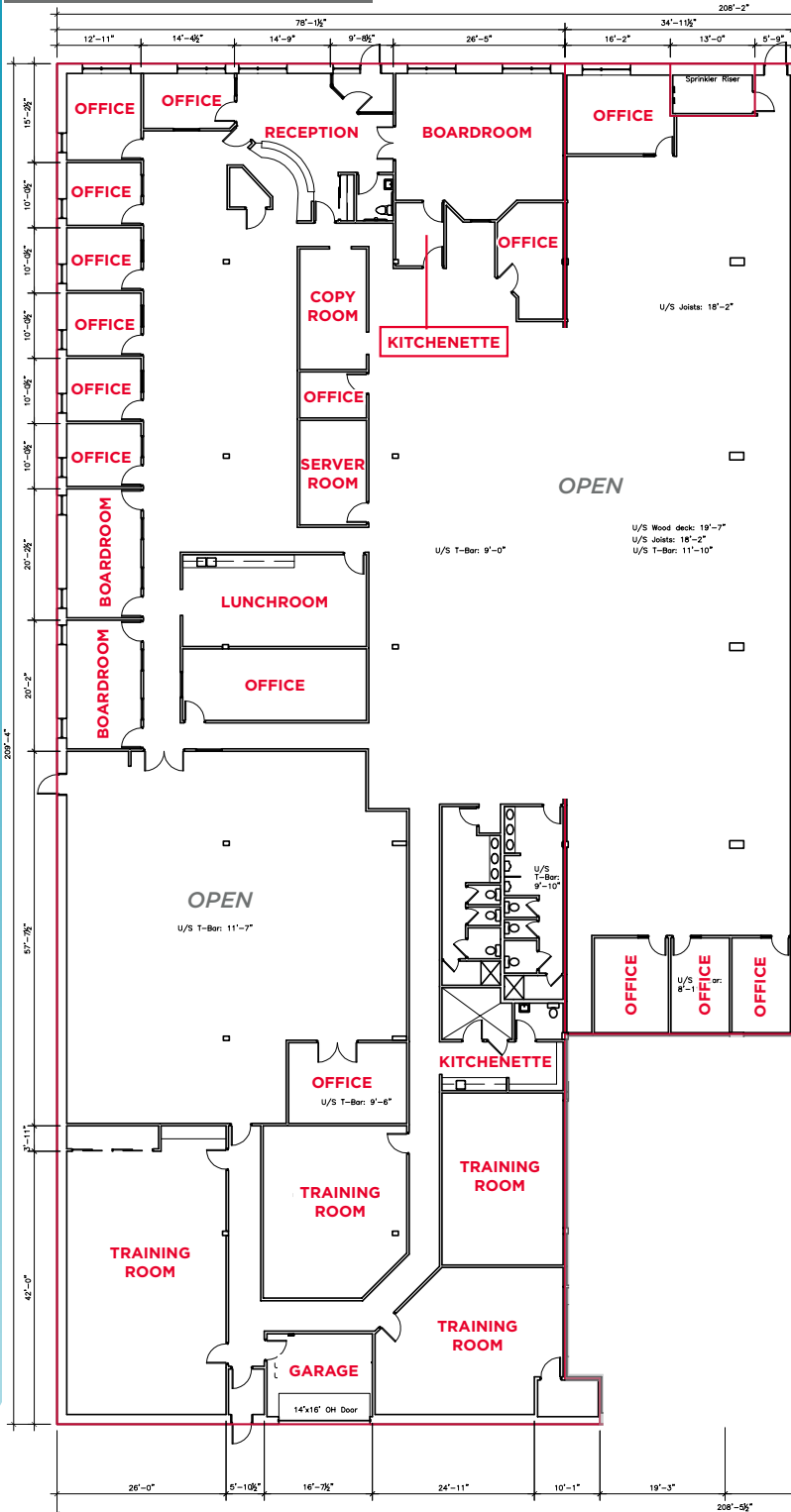

(+/-) 21,503 sf Available

Offices	15
Boardrooms	3
Kitchenettes	2
Lunchroom	1
Training Rooms	4
Tech Rooms	2
Garage	1

FOR LEASE
Unit A 1000 Waverley St

SITE PLAN

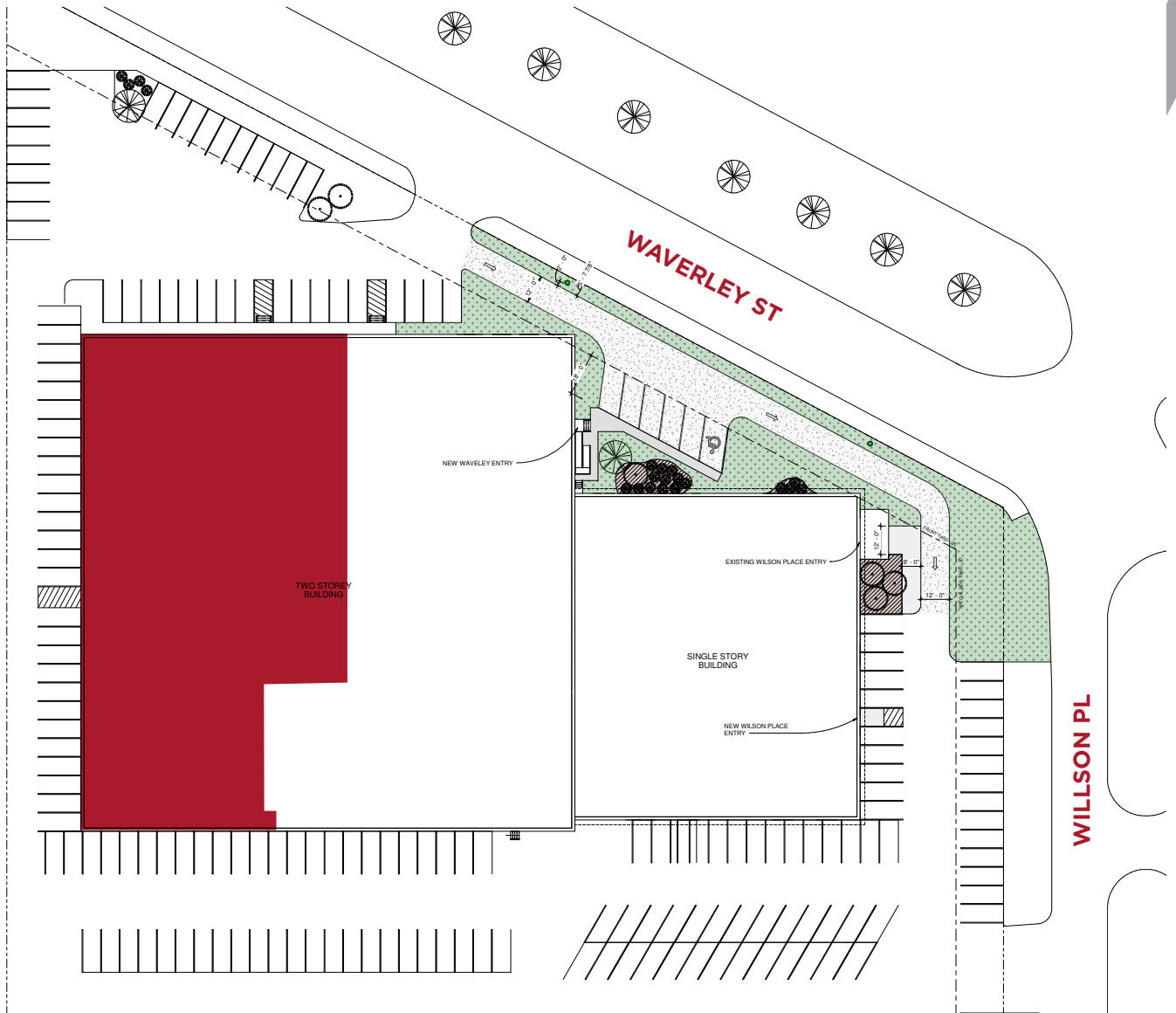

FOR LEASE Unit A 1000 Waverley St



DEMOGRAPHICS

	POPULATION	MEDIAN AGE	AVERAGE HHI	TOTAL HOUSEHOLDS
1KM	4,174	48	\$146,833.91	1,707
3KM	49,042	43	\$107,706.96	21,168
5KM	148,431	41	\$113,324.96	64,588

Independently Owned and Operated / A Member of the Cushman & Wakefield Alliance ©2025 Cushman & Wakefield. All rights reserved. The information contained in this communication is strictly confidential. This information has been obtained from sources believed to be reliable but has not been verified. NO WARRANTY OR REPRESENTATION, EXPRESS OR IMPLIED, IS MADE AS TO THE CONDITION OF THE PROPERTY (OR PROPERTIES) REFERENCED HEREIN OR AS TO THE ACCURACY OR COMPLETENESS OF THE INFORMATION CONTAINED HEREIN, AND SAME IS SUBMITTED SUBJECT TO ERRORS, OMISSIONS, CHANGE OF PRICE, RENTAL OR OTHER CONDITIONS, WITHDRAWAL WITHOUT NOTICE, AND TO ANY SPECIAL LISTING CONDITIONS IMPOSED BY THE PROPERTY OWNER(S). ANY PROJECTIONS, OPINIONS OR ESTIMATES ARE SUBJECT TO UNCERTAINTY AND DO NOT SIGNIFY CURRENT OR FUTURE PROPERTY PERFORMANCE.

Ryan Munt
Executive Vice President

Ryan Munt Personal Real Estate Corporation
T 204 928 5015
C 204 298 1905
ryan.munt@cwstevenson.ca

Karin Thielmann
Senior Associate

T 204 934 6226
C 204 470 4715
karin.thielmann@cwinnipeg.com

Independently Owned and Operated / A Member of the Cushman & Wakefield Alliance ©2025 Cushman & Wakefield. All rights reserved.
The information contained in this communication is strictly confidential.

This information has been obtained from sources believed to be reliable but has not been verified. NO WARRANTY OR REPRESENTATION, EXPRESS OR IMPLIED, IS MADE AS TO THE CONDITION OF THE PROPERTY (OR PROPERTIES) REFERENCED HEREIN OR AS TO THE ACCURACY OR COMPLETENESS OF THE INFORMATION CONTAINED HEREIN, AND SAME IS SUBMITTED SUBJECT TO ERRORS, OMISSIONS, CHANGE OF PRICE, RENTAL OR OTHER CONDITIONS, WITHDRAWAL WITHOUT NOTICE, AND TO ANY SPECIAL LISTING CONDITIONS IMPOSED BY THE PROPERTY OWNER(S). ANY PROJECTIONS, OPINIONS OR ESTIMATES ARE SUBJECT TO UNCERTAINTY AND DO NOT SIGNIFY CURRENT OR FUTURE PROPERTY PERFORMANCE.

